

TECHNICAL DATA SHEET



KRASO® System Sealing Insert KDS 150 Universal Multiple – split

Application area

For installation of one or several media lines/cables, split design for the retrofit installation in **KRASO®** Cable Penetrations KDS 150.

Product information

- + With Torque Control Nut **KRASO®** DKM: integrated torque limiter – no torque wrench required
- + Axial bending of the media lines up to 8° possible

Tests

- + Certified with the quality seal of the FHRK e. V.
- + Radon tightness IAF tested - meets the requirements for radon precautionary areas according to FHRK leaflet MB 101
- + MPA-tested gas- and water pressure tightness up to 2,5 bar
- + DafStB waterproof concrete guideline: stress class 1 + 2



Material

Clamping plates	non-corrosive stainless steel
Bolts	non-corrosive stainless steel
Washers	non-corrosive stainless steel
Nuts	Torque Control Nut KRASO® DKM
Seal	EPDM 50° +/-5° Shore

TECHNICAL DATA SHEET

KRASO® System Sealing Insert KDS 150 Universal Multiple – split

Technical drawing

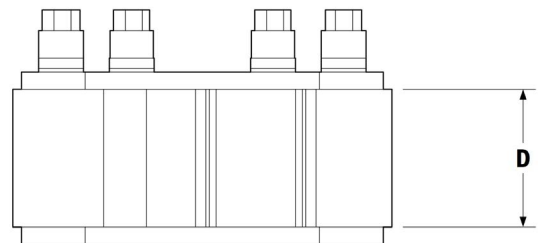
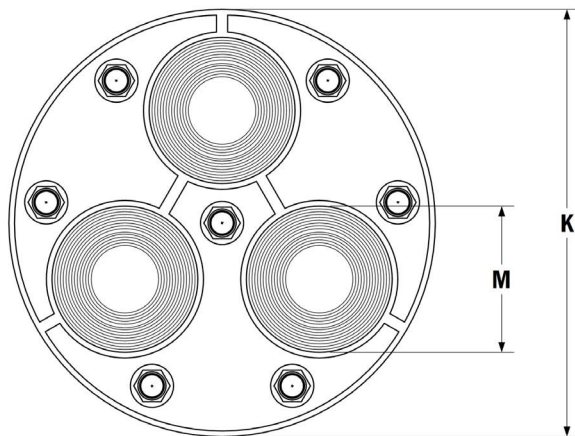

K = external diameter | **M** = media line | **D** = seal

Type	K (mm)	M (mm)	D (mm)	Weight (kg)	Item Nr.
Universal	160	1 x 63, 75, 90 or 110	30	1,48	KKDS150DIUNIG
Design 1	160	3 x 6 - 52 or blind	30	1,45	KKDS150DIMUNIG1
Design 2	160	4 x 6 - 18 or blind 6 x 6 - 33 or blind	30	1,41	KKDS150DIMUNIG2
Design 3	160	6 x 6 - 38 or blind	30	1,41	KKDS150DIMUNIG3