

# ift-Nachweis



|                  |  |
|------------------|--|
| Number           | 20-004396-PR01 (NW-E03-020310-en-01)   |
| Owner            | SIGA Cover AG<br>Rüt mattstr. 7<br>6017 Ruswil<br>Switzerland  |
| Product          | Sealing system between window and building structure<br>(plastered in reveal)  |
| Designation      | SIGA Meltell ® 300   |
| Details          | Installation conditions<br>Masonry reinforced concrete; Substratum/Adhesive surface plastered<br>in reveal; window PVC-window, 1,230 mm x 1,480 mm with<br>glass configuration 4 / 16 / 4, centered in the reveal; fixing<br>screws, lateral and at top, fixing distance lateral $\leq 700$ mm;<br>lateral securing with screws; load transmission spacer blockings at<br>bottom |
| Special features | The external bottom joint was not part of the test.  |

## Result

Valuation of joint-properties according to ift-guideline MO-01/1:2007-01 -  
section 5.4 (detail results on page 2)



**Requirement: fulfilled**

ift Rosenheim  
01.02.2021

Thomas Stefan, Dipl.-Ing. (FH)  
Head of Testing Department  
Building Component Testing

Thomas Krichbaumer  
Operating Testing Officer  
Building Component Testing

## Basis

ift-Guideline MO-01/1 2007-01

Test report: 20-004396-PR01 PB-  
E03-020310-de-01

## Representation

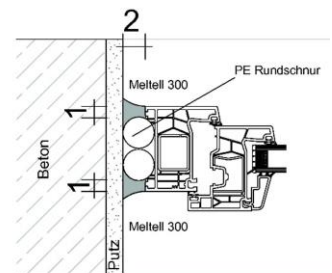

## Instructions for use

The results obtained can be used  
as evidence in accordance with  
the above basis.

## Validity

There is no time limit.  
When using this document the up-  
to-dateness of above basis and  
the conformity of the product have  
to be observed.

The data and results given relate  
solely to the tested and described  
specimen. This test does not  
allow any statement to be made  
on further characteristics of the  
present structure regarding per-  
formance and quality.

## Notes on publication

The ift-Guidance Sheet "Condi-  
tions and Guidance for the Use of  
ift Test Documents" applies.

## Identity-Check



[www.ift-rosenheim.de/ift-geprueft](http://www.ift-rosenheim.de/ift-geprueft)  
ID: 0B2-ABAEF

## Summary of results

| Assessment                         | Tested performance characteristics   | Test results  |
|------------------------------------|--|---|
| ift-Guideline MO-01/1, section 5.4 | Receiving inspection according to ift-Guideline MO-01/1:2007-01                                  | <b>Requirements fulfilled</b>   |
|                                    | Watertightness in new condition following EN 1027:2016-03  | <b>No water penetration at up to 600 Pa</b>   |
|                                    | Air permeability in new condition according to EN 12114:2000-03                                  | <b><math>a &lt; 0,1 \text{ m}^3/[\text{m}^*\text{h}*(\text{daPa})^{2/3}]</math></b> |
|                                    | Thermal cycling according to ift-Guideline MO-01/1:2007-01                                       | <b>Requirements fulfilled</b>   |
|                                    | Mechanical durability following EN 1191:2000-02  | <b>Requirements fulfilled</b>   |
|                                    | Resistance to wind load - alternating positive and negative pressures following EN 12211:2016-03 | <b>Requirements fulfilled</b>   |
|                                    | Air permeability after load tests according to EN 12114:2000-03                                  | <b><math>a &lt; 0,1 \text{ m}^3/[\text{m}^*\text{h}*(\text{daPa})^{2/3}]</math></b> |
|                                    | Watertightness after load tests following EN 1027:2016-03  | <b>No water penetration at up to 600 Pa</b>   |
|                                    | Dismantling and inspection according to ift-Guideline MO-01/1:2007-01                            | <b>Requirements fulfilled</b>   |

The test specimen fulfils the requirements of ift-Guideline MO-01-1:2007-01, section 5.4 within the scope:

- **Internal and external (external lateral and at top)**